

8.Mechanical :

8.1 Weight : 186 g Typical

8.2 Cable Type : Black UL2468 18AWG
(Wire + Plug)

Plug : $\phi 5.5 * \phi 2.1 * 9.5\text{mm}$
(Tuning Fork & Cannelure)

Cable Drawing No. : ADT-1926

8.3 Cable Length : 1500mm

8.4 Case Dimension : 87.5mm(L)*50mm(W)*33mm(H)

8.5 Material Flammability : UL 94V-0

8.6 External Apperance : As drawing below (Scale \rightarrow mm)

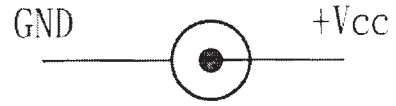

Output Cable Plug Pin Assignment

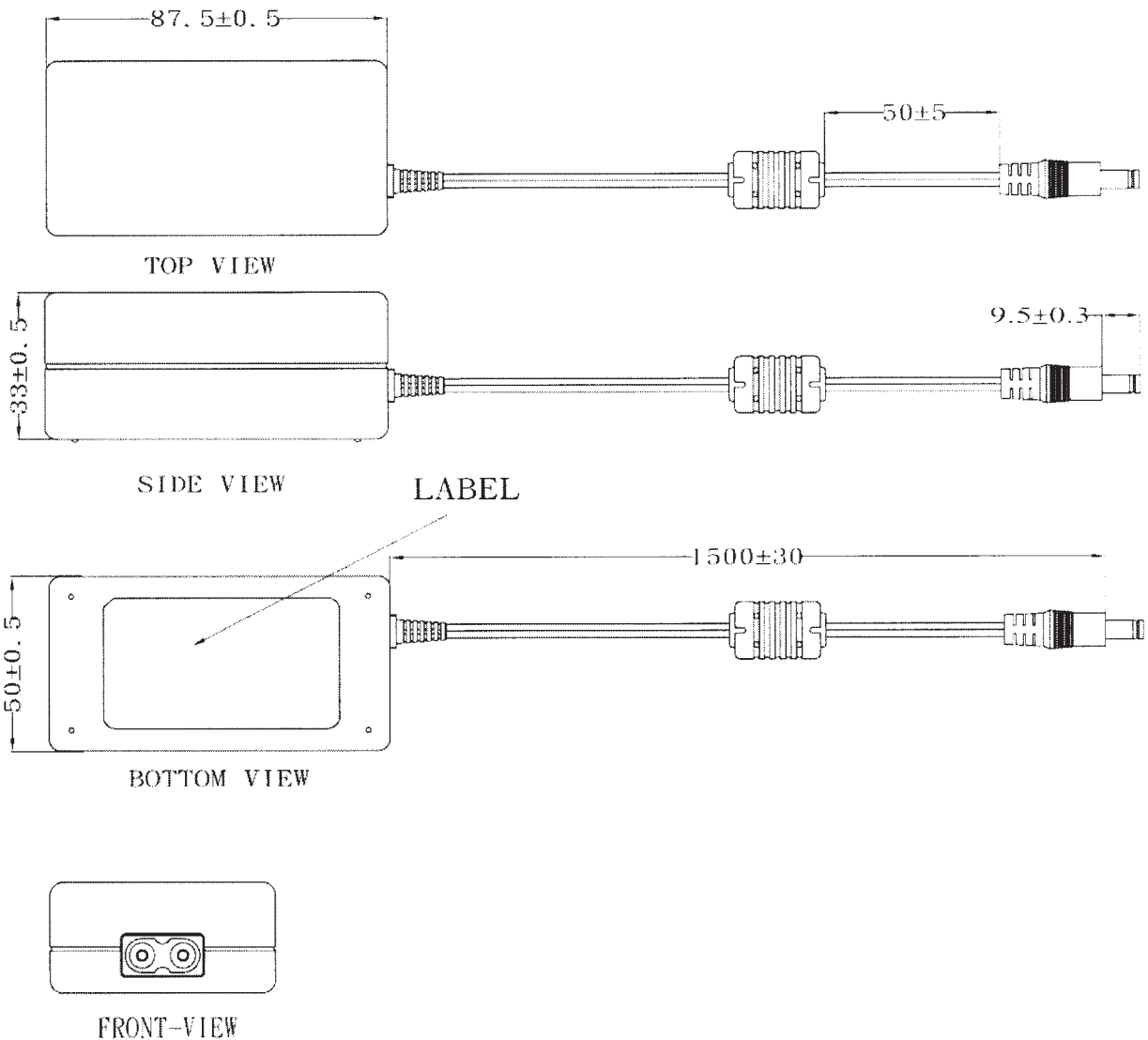
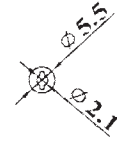
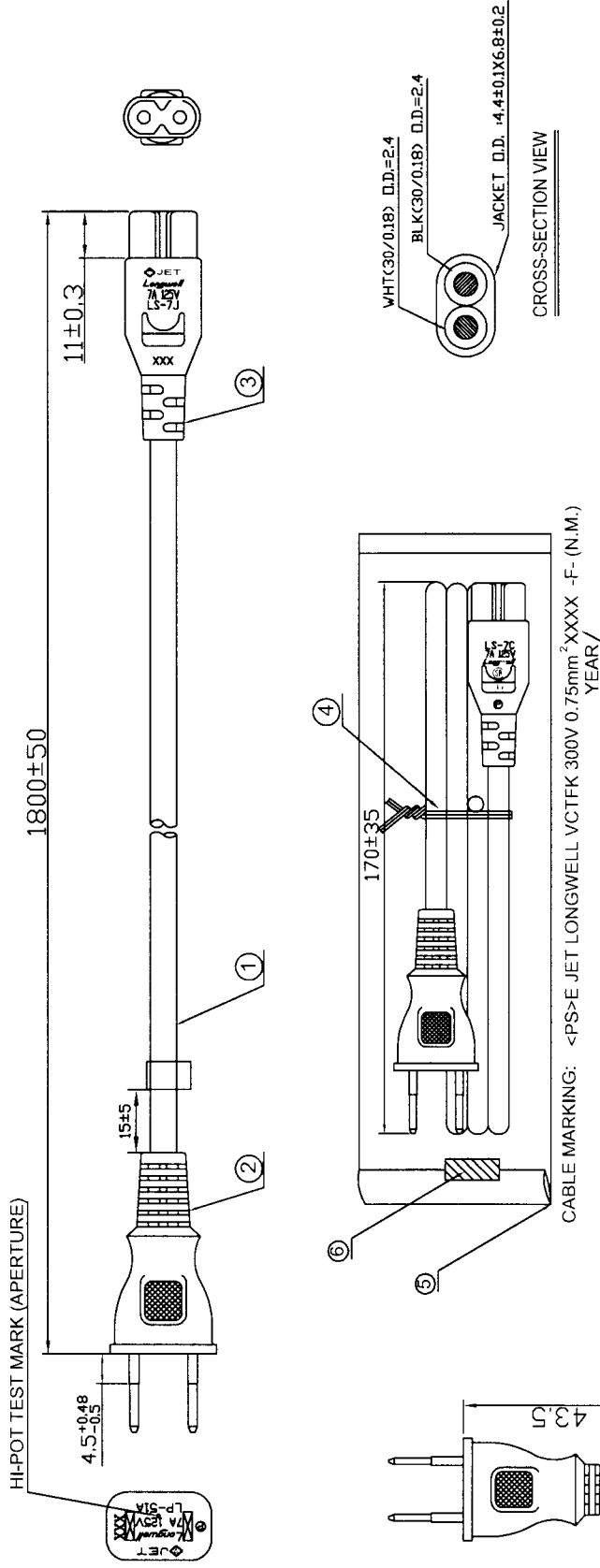
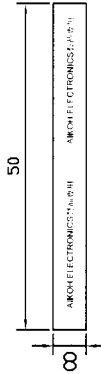

FIGURE 1



ITEM	DESCRIPTION	QTY	U/M
6	TAPE	1	EA
5	PE BAG	1	EA
4	MINI TIE	1	EA
3	(MOLDED CONNECTOR) LS-7C/7J 7A/125V	1	EA
2	(MOLDED PLUG) LP-51A 7A/125V	1	EA
1	VCTFK 0.75mm ² C BLACK 511" N.M.	1	EA

Approved by:	C.F.Y	Customer:	AIKO
Checked by:	Tony.Chen	Customer P/N:	
Drawn by:	Lingling.Pei	Longwell P/N:	PP8FAQNBK0A-05B
Date:	05/13/2010	DWG. NO:	GW-06127
Angle:		Scale:	X Unit: mm
Tolerance:	>0±0.3	Specification Use Only	
	>1±0.5		
	>10±1		
	>20±2		



- NOTES:
- CABLE: THE CORD SHALL COMPLY WITH ARTICLE 1 OF THE TECHNICAL REQUIREMENTS OF THE METI ORDINANCE APPENDIX 1 SECTIONS (1),(6),(10).
 - PLUG: THE MOLDED PLUG SHALL COMPLY WITH ARTICLE 1 OF THE TECHNICAL REQUIREMENTS OF THE METI ORDINANCE APPENDIX 4 SECTION 1 & 6.
 - CONNECTOR: THE MOLDED CONNECTOR SHALL COMPLY WITH ARTICLE 1 OF THE TECHNICAL REQUIREMENTS OF THE METI ORDINANCE APPENDIX 4 SECTION 1 & 6 AND IEC 60320-1 STANDARDS (C7 CONNECTOR).
 - THE PRODUCT SHALL BE TESTED 100 % FOR ALL SAFETY ELECTRICAL ITEMS.
 - COLOR: BLACK (LONGWELL P/N:0A).

REV	ECN NO	DESCRIPTION	APP'D.	DATE
1		Original Picture		05/13/10